

Needle roller and cage assemblies | Złożenia igielkowe

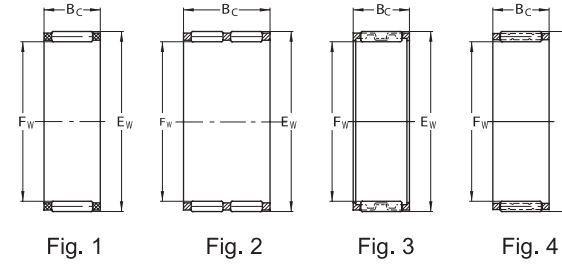
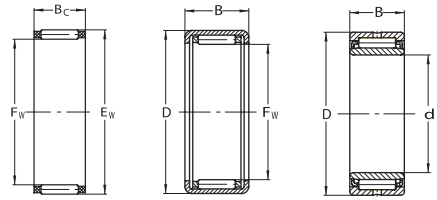

PREFIX		Characters placed before basic designation
		Znaki umieszczone przed oznaczeniem podstawowym
KBK		special cage for gudgeon pin bearing ● koszyk specjalny do sworznia tłokowego
KZK		special cage for crank pin bearing ● koszyk specjalny do łożyska czopu korbowego
SUFFIX		Characters placed after basic designation
		Znaki umieszczone za oznaczeniem podstawowym
	TNG	polyamid cage ● kosz poliamidowy
	V	bearing without cage with full quantity of rolling elements łożysko bez koszyka z pełną ilością wałków
	2RS	rubber seals at both sides of bearing ● dwie uszczelki gumowe z obu stron łożyska

DIMENSIONS			BASIC LOAD RATING		BEARING DESIGNATIONS	MASS	FIG No
WYMIARY GŁÓWNE			NOŚNOŚĆ				
Fw	Ew	Bc	dynamic dynamiczna C	static statyczna C ₀	OZNACZENIE ŁOŻYSKA	MASA ~	NR RYS.
mm			kN			kg	
12	17.000	14.2	8.00	9.50	KBK 12x17x14.2	0.008	4
	18.000	12.0	9.25	8.75	K 12x18x12 TNG	0.0060	1
14	18.000	10.0	6.80	8.30	K14x18x10	0.0048	1
	20.000	13.0	9.70	11.00	K15x20x13	0.0089	1
15	25.000	37.0	34.60	37.50	612-735 TN	0.0420	1
	16	20.000	10.0	7.60	9.70	K16x20x10	0.0057
20.000		23.0	13.40	19.50	KK 16x20x23 TNG	0.0080	2
17	22.000	12.0	10.60	11.10	KZK 16x22x12	0.0095	3
	21.000	13.0	10.46	14.60	K 17x21x 13	0.0065	1
18	22.000	17.0	9.60	13.10	KBK 18x22x17	0.0108	4
	19	28.575	36.5	40.40	48.80	612-695 TNG	0.0460
28.575		43.0	46.00	57.50	612-696 TNG	0.0560	1
20	25.300	19.8	18.40	23.70	F-52590	0.0172	1
	26.000	17.0	19.90	24.80	K 20x26x17	0.0182	
22	26.000	20.0	13.70	24.00	HK2020	0.0241	1
	28.000	17.0	19.40	27.00	K 22x28x17	0.0180	1
25	29.000	16.0	17.80	21.20	KZK 22x29x16	0.0156	3
	33.336	25.4	36.20	51.00	C 162116	0.0726	1
28	33.000	13.0	14.90	22.80	K 28x33x13	0.0152	1
	35.000	16.0	21.50	29.50	K 28x35x16	0.0240	1
30	34.000	32.5	24.20	51.00	KK 30x34x32.5 TNG	0.0194	2
	32	38.000	20.0	26.50	45.00	K 32x38x20	0.0300
40.000		25.0	37.50	58.00	K 32x40x25	0.0500	1
35	40.000	30.0	24.70	47.00	KK 35x40x30	0.0430	2
	42.000	16.0	24.40	37.50	K 35x42x16	0.0340	1
35	42.000	30.0	39.00	68.00	K 35x42x30	0.0670	1
	45.000	20.0	37.00	50.00	K 35x45x20	0.0560	1
40	45.000	17.0	23.50	46.00	K 40x45x17	0.0254	1
	45.000	21.0	22.50	44.00	K 40x45x21	0.0365	1
45	50.000	20.0	23.70	48.40	K 45x50x20	0.0310	1
	53.000	21.0	38.90	66.00	K 45x53x21	0.0580	1
60	65.000	20.0	29.50	72.00	K 60x65x20	0.0520	1
	115	123.000	27.0	63.00	170.00	K 115x123x27	0.2000

Drawn cup needle roller bearings | Łożyska cienkościenne

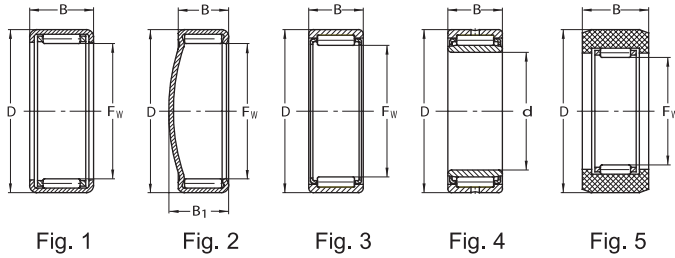

DIMENSIONS				BASIC LOAD RATING		BEARING DESIGNATIONS	MASS	FIG No
WYMIARY GŁÓWNE				NOŚNOŚĆ				
Fw	D	B	B ₁	dynamic dynamiczna C	static statyczna C ₀	~		
mm				kN			kg	
5.000	9.000	9.00		2.01	1.75	HK 0509	0.0020	1
6.000	10.000	8.00		2.03	1.65	HK 0608	0.0021	1
	10.000	9.00		2.22	2.04	RHNA 061009	0.0026	1
8.000	12.000	10.00		0.08	3.95	HK 0810	0.0030	1
10.000	14.000	10.00		4.55	5.70	HK1010	0.0040	1
	14.000	12.00		5.50	6.80	HK1012	0.0048	1
	15.000	9.60		5.90	8.30	311-687V	0.0066	2
	16.000	8.95	10.15	6.50	7.30	F-43088	0.0070	2
	16.000	12.00		5.30	5.55	RHNA 101612	0.0080	1
12.000	16.000	10.00		4.15	5.80	HK1210	0.0052	1
	16.000	12.00		3.80	5.10	HK1212	0.0056	1
	18.000	9.95	10.70	8.25	10.40	F-82868	0.0090	2
	18.000	9.95		8.25	10.40	311-748 V	0.0090	2
14.000	20.000	12.00		6.10	7.75	HK 1412	0.0105	1
	22.000	13.00		8.06	9.00	RNA4900	0.0244	3
15.000	21.000	12.00		7.00	8.40	HK1512	0.0111	1
15.875	20.638	12.70		7.00	10.90	SCE 108	0.0109	1
16.000	22.000	16.00		10.90	15.30	HK 1616	0.0160	1
17.000	23.000	12.00		7.90	10.30	HK 1712	0.0120	1
	23.000	22.00		12.50	20.60	RHNA 172322 A	0.0217	1
18.000	24.000	12.00		7.10	9.90	HK1812	0.0131	1
	24.000	16.00		10.30	16.30	HK 1816	0.0175	1
19.000	36.100	19.00		10.60	13.20	373-692 X1	0.0280	5*
	37.700	19.00		10.60	13.20	373-692	0.0280	5*
	38.000	19.00		10.60	13.20	373-692 X2	0.0280	5*
19.050	25.400	19.05		13.70	21.20	SCE 1212	0.0226	1
20.000	26.000	20.00		15.70	26.00	HK2020	0.0240	1
22.248	34.925	25.40		29.40	37.40	313-641	0.0870	3
25.000	32.000	16.00		15.60	24.00	HK 2516	0.0270	1
	32.000	20.00		17.80	31.50	HK 2520	0.0341	1
	42.000	17.00		23.50	30.50	NA 4905	0.0913	4
25.400	38.100	25.40		31.90	43.10	F-92090	0.0900	3
30.000	37.000	16.00		17.20	29.00	HK 3016	0.0310	1
	37.000	26.00		25.80	53.50	HK 3026	0.0594	1
	38.000	20.00		21.50	37.30	RHNA 303820 X1	0.0460	1
	42.000	17.00		23.50	30.50	RNA 4905	0.0610	3
	47.000	17.00		25.50	39.00	NA4906	0.0810	4
31.750	44.450	25.40		35.80	53.00	F-92091	0.1088	3
	47.625	31.75		56.00	77.00	313-644	0.1850	3
34.925	14.275	12.70		11.80	21.90	SCE 228	0.0280	1
35.000	41.000	12.00		11.30	19.40	HK 3512	0.0277	1
40.000	47.000	20.00		25.50	52.00	HK 4020	0.0540	1
41.161	49.327	16.10		21.10	39.00	F-47905	0.0516	1
50.800	60.325	25.40		37.70	78.00	SCE 3216	0.1080	1
60.000	68.000	20.00		30.50	72.00	HK6020	0.0860	1

*Fig. no. 5 – Needle roller bearing with rubber sleeve. / Łożysko igielkowe w tuleji gumowej

